

Road Fence and TORUN Lifting Yoke

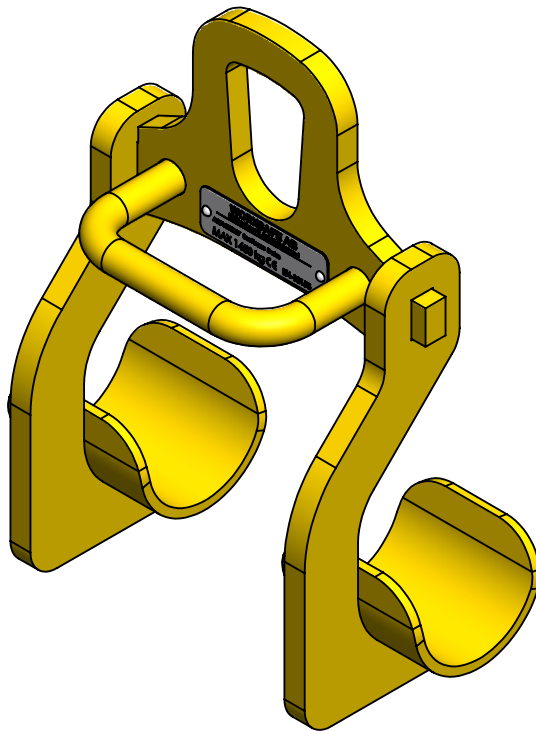

[mm]

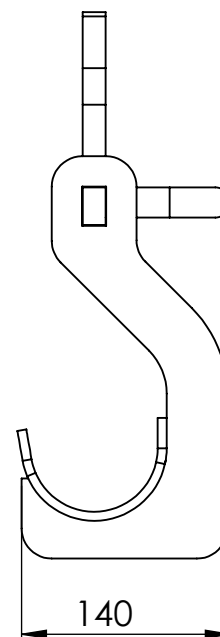
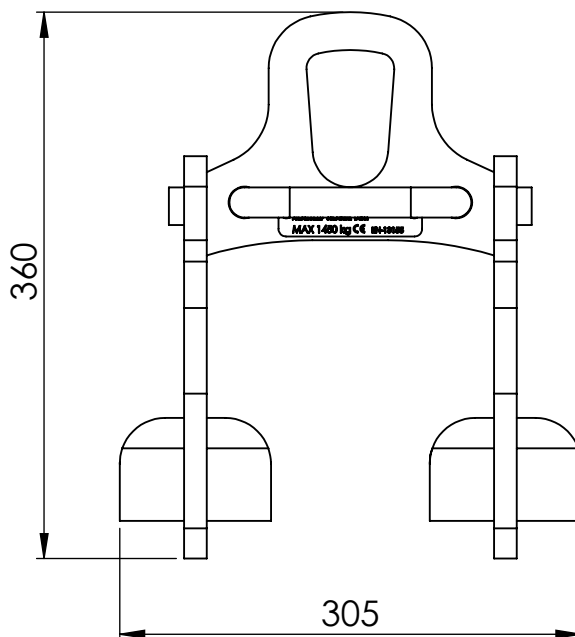

Technical Data

- Article number: 833227.
- Lifting capacity: Max 1450 kg.
- Height: 360 mm.
- Width: 305 mm.
- Depth: 140 mm.
- Weight: 7,5 kg.

The serial number can be found on the attached marking plate.

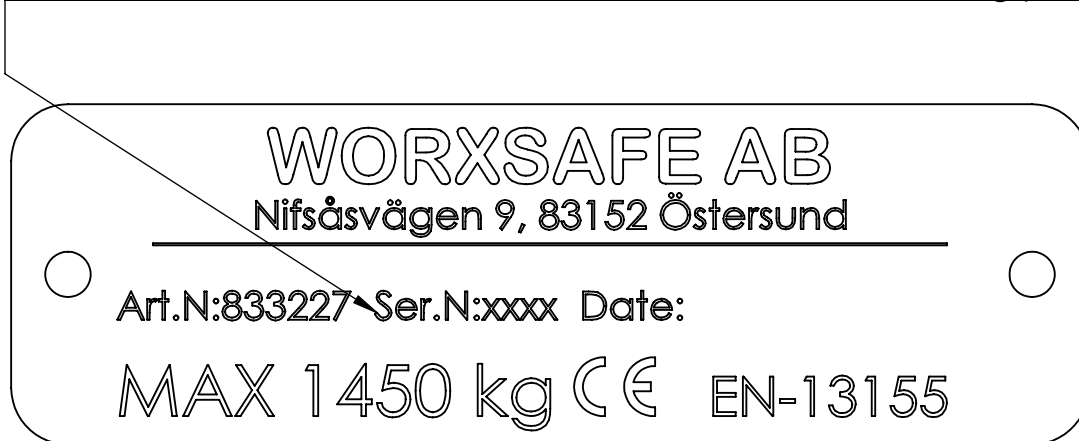



Instruction

Read the entire manual before using the equipment. Failure to comply with the mentioned safety precautions can lead to injury or death.

Safety Directives

The equipment is approved according to the following standards:

- EN ISO 12100
- EN 13155+A2:2009
- EG-directive 2006/42/EG.

Contact

For questions regarding the equipment, contact the manufacturer:

Worxsafe AB
Nifsåsvägen 9
83152 Östersund
Sverige

Tel: +46 (0)63-10 67 73
Email: info@worxsafe.com



Description

Worxsafe Road Fence and TORUN Lifting Yoke is intended for lifting Worxsafe Road Fence and TORUN Barrier, these can be handled one at a time up to a maximum weight of 1450 kg.

Intended Use

All users of the lifting yoke should read and understand the manual before using the equipment.

The lifting yoke is only intended to lift Road Fence and TORUN Barriers. Only one unit at a time may be lifted and the weight can not be more than 1450 kg. Make sure that the barrier is free from dirt and ice before lifting, this can otherwise cause the lifting yoke to be over loaded.

The lifting yoke is only intended for vertical lifting. If used for horizontal dragging the hooks may slip on the top tube and cause serious damage to people or property.

The equipment may only be used in the temperature range between -20°C and +50°C.



Lifting anything that is not mentioned above or lifting outside of the given temperature range is not allowed as the lifting yokes function can not be guaranteed under those circumstances.



The lifting yoke may not be used to handle dangerous goods.

Attachment to Crane

The lifting yoke is attached to a crane by using an approved lifting hook through the lifting yokes centre plate.



Using a lifting hook that is not approved may lead to a dropped load.

Instructions for Lifting

Before lifting, check that the barriers top tube is not damaged in a way that hinders the lifting yokes grip

Place the lifting yoke centred over the barrier with the road fences centre tube or the TORUN barriers centre guide plate in the opening between the lifting yokes hooks.

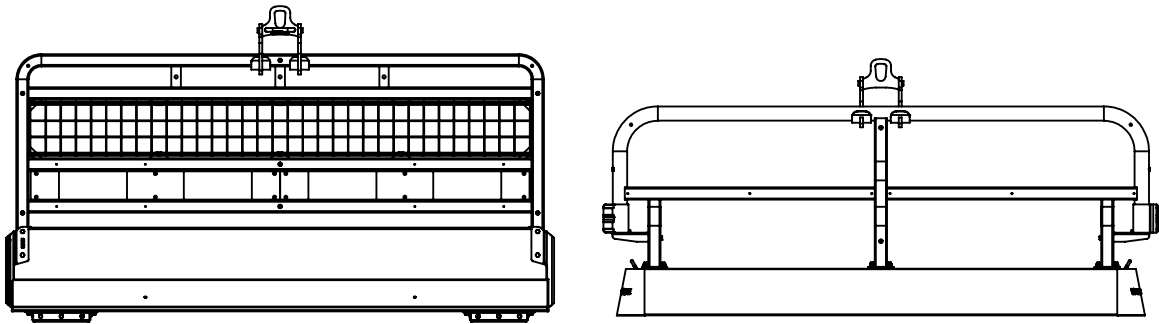

Check that the lifting yoke surrounds the lower half of the top tube and then start lifting slowly.

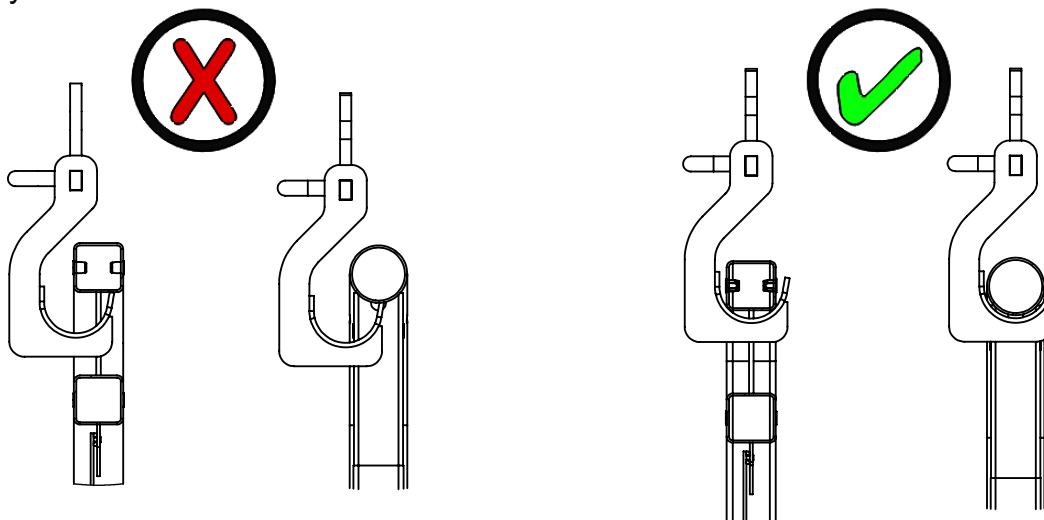

Be mindful if the barrier starts rotating. If a rotation is present, lower the barrier immediately and make sure that no person or object is located within the barriers range of motion before continuing the lift.

When lowering the barrier, first check that the ground is flat and stable. Then lower the barrier slowly until the hooks on the lifting yoke no longer grips the top tube.

Make sure that only one barrier is being lifted. Units that stick to each other may lead to the lifting Yoke becoming overloaded. Also make sure that the barrier is not stuck to the ground.

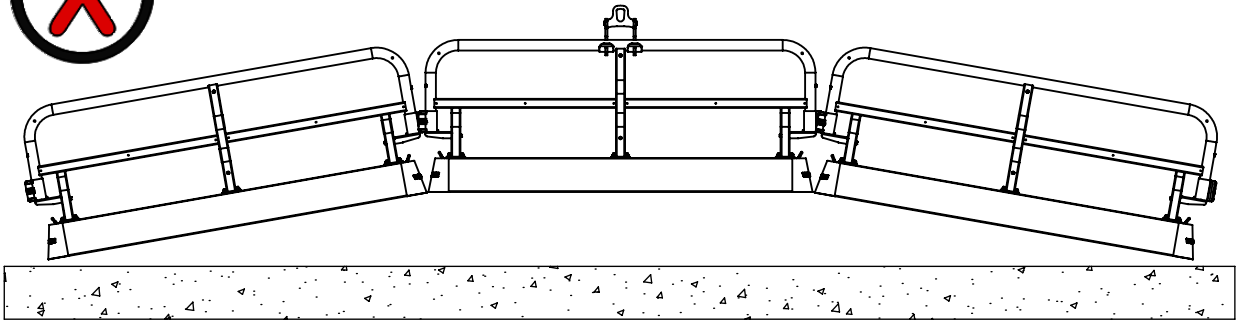

Always use the lifting yokes handle when handling it manually. Placing your hands anywhere else increases the risk of injury.



A damaged top tube on the barrier may lead to an insufficient grip for the lifting yoke.

Assembly & Maintenance

The lifting yoke should be checked regularly according to the interval mentioned below.

- Yearly: Control of the lifting yokes structural integrity. (Cracks or corrosion)

Any defects should be corrected before further use.



Welding the lifting yoke is not allowed. If cracks or other defects are noticed the lifting yoke may not be used. Contact the manufacturer for further consultation. For major defects the lifting yoke should be discarded.

Storage













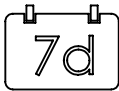

Always store the lifting yoke standing up on a flat and even surface. If placed on a leaning or uneven surface it risks tipping over.

GENERAL

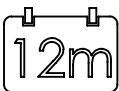
- Always read the manufacturer's instructions to ensure that the product is used correctly and safely.
- If anything is unclear, contact the manufacturer or your retailer.
- Never mix products from different manufacturers.
- Do never exceed the specified load limits.

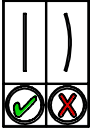
STORAGE

- Store as far as possible in non-corrosive environment.
- Store the products according to the manufacturer's intended way for example when stacking to minimize the risk of personal injury.

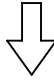
 Technical information	 Weight	 Nm Tighen with torque
 Inspect	 Recycling	 Loosen
 Inspection interval (days)	 Correct	 Max allowed wind speed
 Inspection interval (months)	 Incorrect	 Force
 Inspect straightness	 Be aware!	 Moment
 Inspect for cracks	 Tighten	 Insert